



W LAYTON AVENUE (CTH Y) RECONSTRUCTION

S 68th Street to S 60th Street | Stage 2



The City of Greenfield plans to reconstruct W Layton Avenue (S 68th Street - S 60th Street) to address deteriorating pavement and improve traffic conditions. **Stage 2** will focus on constructing the eastbound lanes of W Layton Avenue with traffic shifted into the westbound lanes. One lane of traffic will be open in each direction. The south half of S 68th Street will be closed. Vehicles may use the median openings to reach the businesses in the work zone.

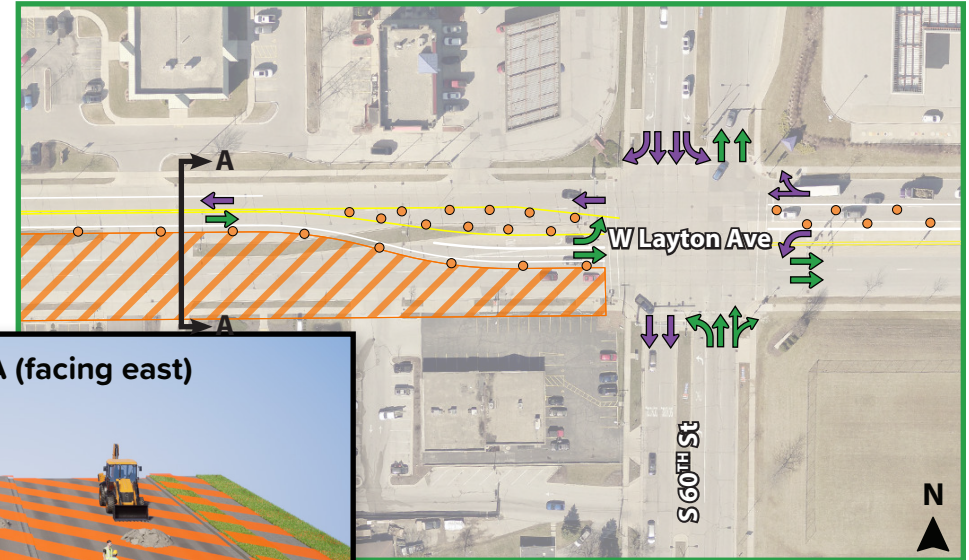
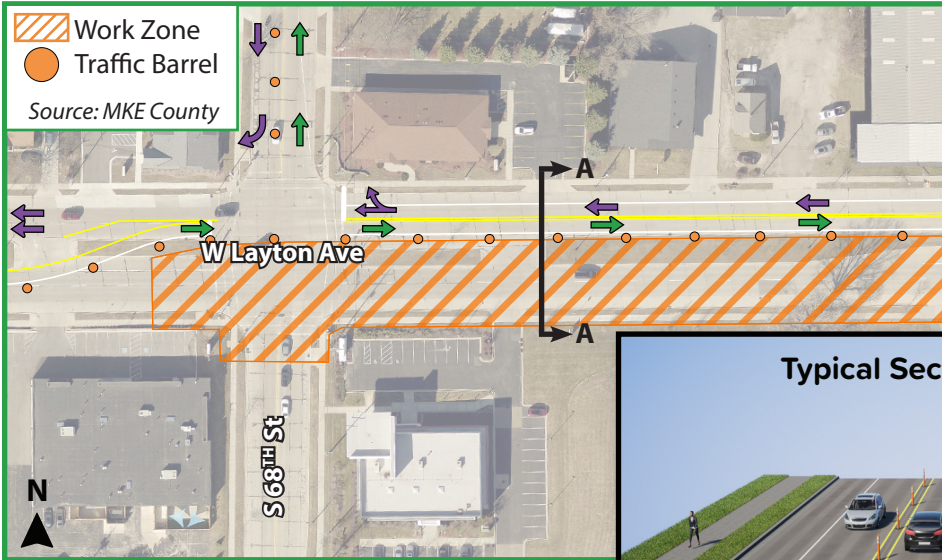

Construction Schedule	
2026	
	MAR APR MAY JUN JUL AUG SEP OCT NOV DEC
Prestage	■
Stage 1	■
Stage 2	■
Stage 3	■

*Schedule is subject to change

Stage 2: Move all traffic to westbound lanes to construct eastbound lanes. S 68th Street southbound will be closed south of W Layton Ave.

*The S 60th Street intersection will be open throughout the project. However, lane reductions, closures, and traffic shifts will be used to construct the south section of the intersection in sub-stages.

Construction Project Contact

Tyler Williams (Lead Inspector)

✉ Tyler.Williams@graef-usa.com

☎ 262-506-8550

Please contact us if you have questions or if you would like to join our email list for project updates.