



# QinFlow Blood Warmer

Paramedic

## PROCEDURE

- ❑ Base Unit (BU) Setup
  - Connect battery to base unit, insert battery, properly lock side latches
  - Press ON switch and ensure at least 2 battery indicator bars are lit up; if not switch batteries
- ❑ Prepare Compact Disposable Unit (CDU)
  - Open sterile CDU sterile package
  - Remove inlet luer cap from inlet tube of CDU marked as 'IN' on CDU casing
  - Connect IV tubing patient end to inlet luer of CDU, tighten until resistance is met (do not over tighten)
  - Remove outlet luer cap from end of outlet tube on CDU
  - Prime tubing and CDU with minimum 20cc NS to remove air from the system
  - Connect outlet tube on CDU to patient's catheter
- ❑ Reset device after completion of patient care
  - Properly dispose of CDU and ensure device is clean of any patient fluids
  - Place battery in charger and device back in carrying case

## REFERENCE GRAPHICS

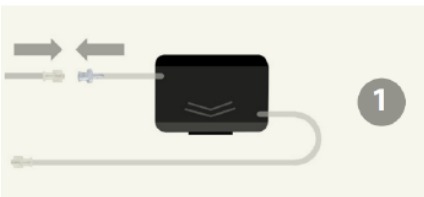

1. CONNECT TUBING TO CDU



2. PRIME BOTH TUBING & CDU

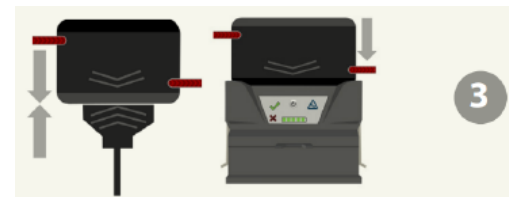

3. CONNECT CDU TO BASE UNIT (or to extension cable)

## KEY POINTS

- The QinFlow Warrior Lite is an inline, battery-powered, portable fluid warmer capable of warming blood products to 38°C
- Base Unit (BU) LED indications panel indicates on/off, fluid outflow temperature, battery charging level
- A fully charged battery can warm at least 4 units of cold blood product
- **MESSAGES AND TROUBLESHOOTING BELOW:**

### MESSAGES & TROUBLESHOOTING SUMMARY

(note: **RED** color indicates that an action is certainly required)

	Warming towards set temperature; make sure you have flow
	Set temperature reached
	Flow rate exceeds battery capacity. Consider reducing the flow
	Battery low. Still considerable volume to give with the Extra Power battery. Continue operating the device. <b>Replace battery when the battery is critically low</b> (all bars blinking)
<b>No Flow</b>	The CDU does not control the flow; hence, it cannot stop the flow. If only gravity fed is applied, it may take 30-60 seconds to prime the CDU with RBC or Whole Blood. Consider using pressure bag or hand pump to speed up the process.
<b>Leakage</b>	Replace CDU; reduce force if operating with manual infusers; report to QinFlow.

**✗ Troubleshooting required**

- 1 Shut the unit off (long press on the on/off button), fix flow complications, ensure that CDU is primed, and reactivate the unit (press on/off button).  
*If not solved:*
- 2 Shut the unit off and replace the CDU with a fully primed one. Unit should start automatically once you connect the CDU; if not, press the on/off button.

**No Display**

- 1 Press on/off button  
*If not solved:*
- 2 Replace battery  
*If not solved:*
- 3 Replace CDU

**Don't use device if display is compromised**