



Grant Park

100 E. Hawthorne Ave.
 South Milwaukee, WI 53172
 Unit Office: (414) 762-1550

- Park Land
- Shrubs & Trees
- Sand Beach
- P** Parking Lot
- Park Building
- Reservable Picnic Area with Shelter, water, and restrooms
**No staking allowed!
 Use sand bags, weights, or water barrels**
- Reservable Picnic Area
**No staking allowed!
 Use sand bags, weights, or water barrels**
- T** Trailhead—7 Bridges Hiking Trail
- Oak Leaf Trail**
 (Paved Multi-Use Trail)
 Trail Segment
- Forked Aster Hiking Trail
- Exceptional Native-Plant Community
- Disc-Golf Course (3 baskets)
- Golf Course (18 holes)
- Soccer Fields
- Tennis Courts
- Tot Lot / Play Area

0 170 340 680 1,020 1,360 Feet
 PARK ACREAGE: 381.1

Pavilion & Picnic Reservations
 (414) 257-8005

Athletic Field Permits
 (414) 257-8030

Parks Information
 (414) 257-PARK (7275)
 countyparks.com

UPDATED APRIL '18

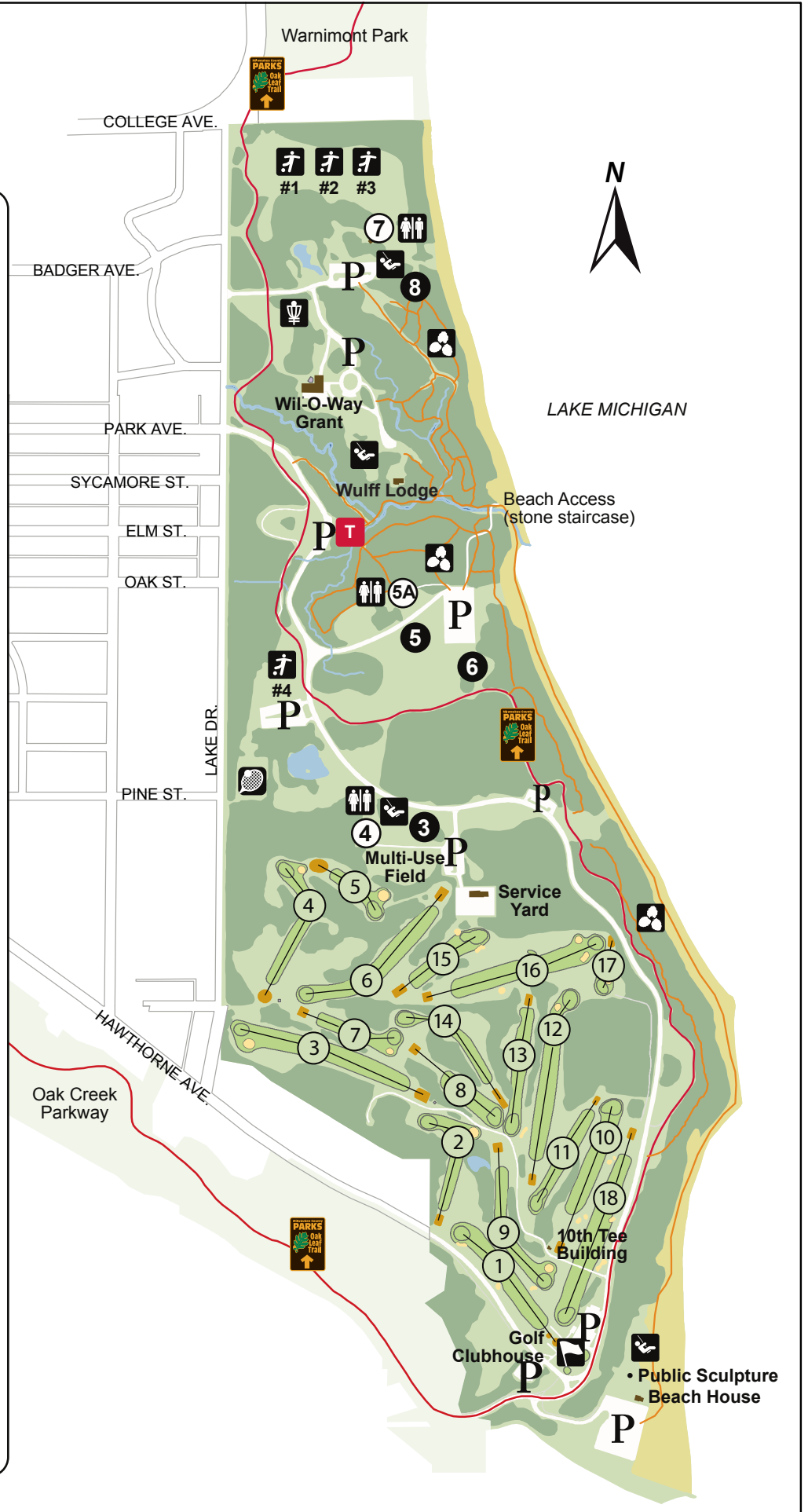

LAKE MICHIGAN

Beach Access (stone staircase)

Oak Creek Parkway

Public Sculpture
 Beach House